

Stephen T. Baxter, Architect, PLLC

Town of Wake Forest  
Public Safety Warehouse  
1412 Forestville Road, Wake Forest, NC 27587  
Bid # 0007-2024

ADDENDUM #2

January 31, 2025

For  
Bid Documents

All Bidders and Plan Holders

Message: Bidders are hereby informed that the following additions, deletions, changes and/or clarifications supersede and supplement the Contract Documents for the above referenced project.

**General**

1. The Bid Date and Time will remain February 5<sup>th</sup>, 2025 at 10:00am. Bidders are welcome to deliver sealed bids to the reception desk at Wake Forest Town Hall prior to the Bid Opening.
2. Civil Bid Form provided with Addendum #1 is to be submitted with Bids and unit prices and amounts filled in. Use this form instead of the form provided in the project manual. This form includes an additional page for unit prices for removal and replacement of unsuitable soils above or below the stated allowances. The additional page is to have the Alternate Unit Prices filled in. This requirement has not changed.

**Architectural**

3. The Owner will handle procurement and installation of the exterior building sign.
4. Add waterproofing membrane adhered to perimeter foundation wall with liquid applied waterproofing and drainage mat with filter fabric facing the exterior perimeter insulation board shown on the architectural wall sections.

**Site**

5. Add a conduit stub out from the IT closet for Fiber to service the new building. See Sheet C6.0 attached.

## Mechanical

6. The main purpose of the CO detectors is for monitoring gas heaters. They may be powered by batteries only or by battery and 120v. If 120v, provide a dedicated circuit for them.

## Electrical

7. Regarding Note 1 on the Power Plan, the specification for the chord reel was provided by the Town of Wake Forest as: L 4545 123 3 – 12/3 45 feet, Premium Duty Single Receptacle Power Chord Reel. The Electrical Contractor is to provide a chord reel equal or better, and provide a submittal for approval by the Town of Wake Forest. Reelcraft's Series L 4000 NEMA 5 – 15R single receptacle power chord reel includes a 15 amp single receptacle with clamp style strain relief. The reel is supplied with a 4 – 5 foot pigtail that includes a NEMA 5 – 15P inlet straight blade plug. For indoor, non-weather tight applications only. "UL/CSA approved".
  - 45 ft. 12/3 SJEOOW cord with single receptacle included.
  - Base plate and upright are constructed from 14 gauge steel; the guide arm is 13 gauge and the spool is 16 gauge steel.
  - A heavy duty collector ring assures highest conductivity.
  - The reliable speed latch allows for positive locking of the spool in two positions per rotation.
  - Individually powder-coated steel components provide maximum protection from premature corrosion.
  - Robotically welded steel base offers maximum strength and consistent quality.
  - Made in USA.

Thank you,  
Stephen T. Baxter, Architect, PLLC

### UTILITY LEGEND

PROPERTY	SYMBOL
WATER LINE	(Symbol)
SEWER LINE	(Symbol)
CANISTER GASER W/L	(Symbol)
STREET	(Symbol)
UTILITY	(Symbol)
UTILITY	(Symbol)
UTILITY	(Symbol)
UTILITY	(Symbol)
UTILITY	(Symbol)
UTILITY	(Symbol)
UTILITY	(Symbol)
UTILITY	(Symbol)
UTILITY	(Symbol)
UTILITY	(Symbol)
UTILITY	(Symbol)

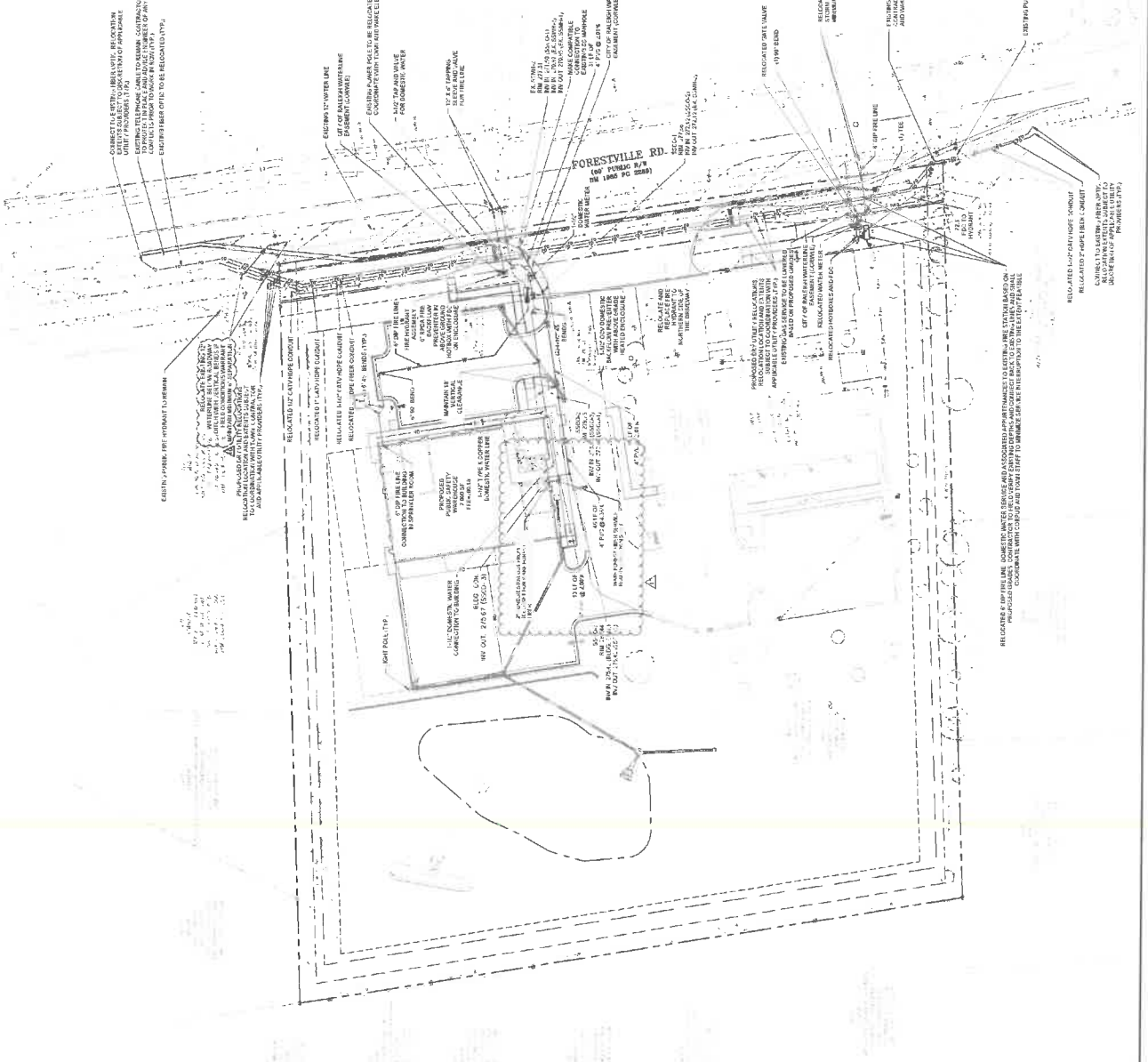
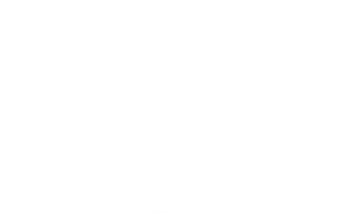

GRAPHIC SCALE IN FEET  
 0 15 30

These plans have been prepared by the undersigned Professional Engineer in accordance with the Professional Engineering and Surveying Act, Chapter 85C, North Carolina General Statutes, and the rules and regulations of the Board of Technical Regulation, State of North Carolina. The undersigned is duly licensed and in good standing as a Professional Engineer in the State of North Carolina, License No. 18000, expiring on 05/25/2026.

I, Joseph S. Kimley-Horn, Inc., a duly licensed Professional Engineering Firm, hereby certifies that these plans were prepared by or under the direct supervision and seal of the undersigned Professional Engineer.

PROFESSIONAL ENGINEER  
 JOSEPH S. KIMLEY-HORN, INC.  
 1500 EAST WAKE FOREST DRIVE, SUITE 200  
 WAKE FOREST, N.C. 27787  
 P. 919.853.1100  
 F. 919.853.1101  
 WWW.KIMLEY-HORN.COM